

NOTES:  
 Boundary information prior boundary survey maps provided by Progress Energy.  
 This map is not prepared for recording.  
 Well coordinates in Elevation Table are NCGS Grid coordinates based on NAD 83.  
 Well elevations are based on Benchmark NCGS "Queensboro", NGVD 29.  
 250' review boundary and 500' compliance boundary are delineated using 4" green, steel, fence posts.

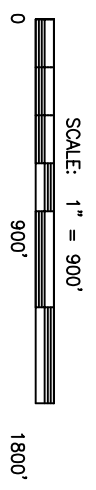

NCGS FINA (NAD 83)  
 N = 204042.5313  
 E = 2307566.6490  
 EI = 21.86 (NGVD 29)

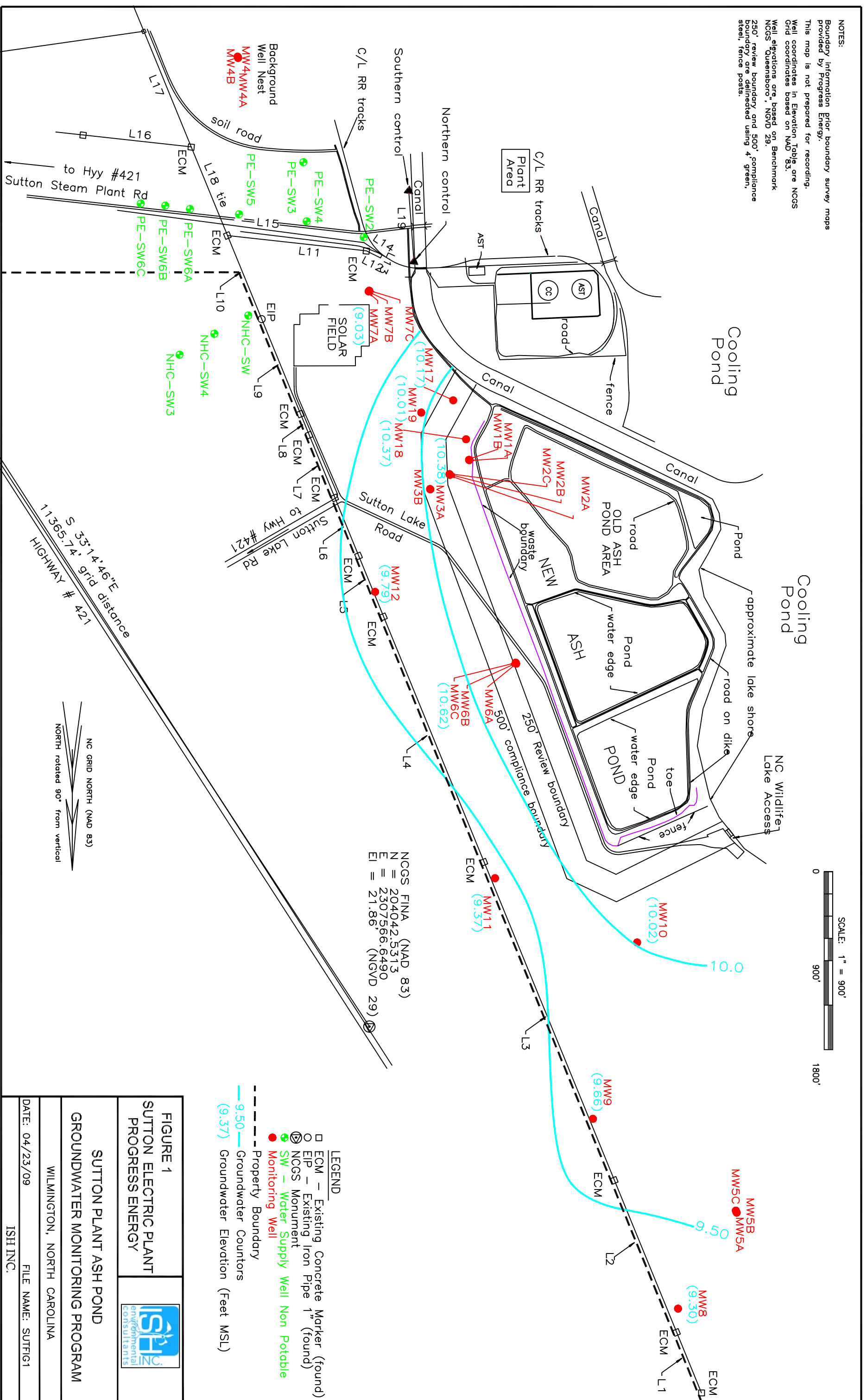
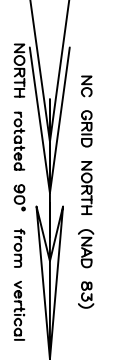

- LEGEND**
- ECM - Existing Concrete Marker (found)
  - EIP - Existing Iron Pipe 1" (found)
  - ⊕ NCGS Monument
  - SW - Water Supply Well Non Potable
  - Monitoring Well
  - Property Boundary
  - - - Groundwater Counters
  - (9.50) Groundwater Elevation (Feet MSL)
  - (9.37) Groundwater Elevation (Feet MSL)

<b>FIGURE 1</b>	
<b>SUTTON ELECTRIC PLANT</b>	
<b>PROGRESS ENERGY</b>	
<b>SUTTON PLANT ASH POND</b>	
<b>GROUNDWATER MONITORING PROGRAM</b>	
WILMINGTON, NORTH CAROLINA	
DATE: 04/23/09	FILE NAME: SUTFIG1
ISH INC.	